

Landscape

MIDDLE EAST | FEBRUARY 2019

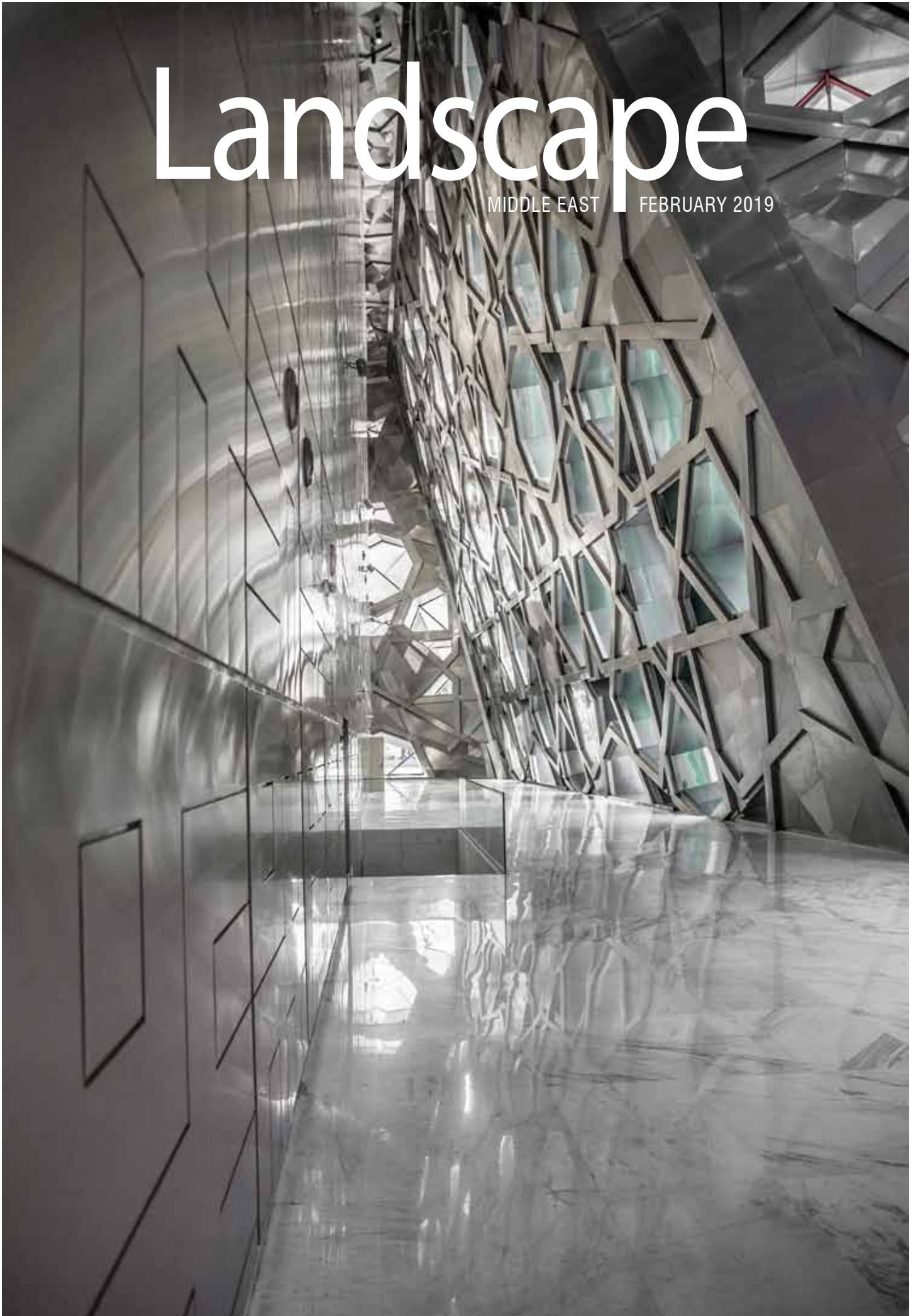



Gover Horticulture LLC
Gover Garden Centre LLC

Tel: +971 4 3809450 , +971 4 3809435, Web: g



- Indoor & Outdoor Green Wall
- Gover Flower Tower

metalco

METALCO.IT

SOCIAL DESIGN FOR REAL LIFE

RIVOLA BENCHES

WTBURDEN
street furniture

www.wtburden.ae

streetfurniture@wtburden.ae

WTB Group

Dubai Office PO Box 261378 \ JAFZA \ Dubai - UAE t +971 4 8860 700 \ f +971 4 8860 701

EDITOR'S NOTE

Welcome to our February issue! As always we have crammed in some of the region's most interesting architectural landscape and design projects for you to get a sneak peek. On page 32 we learn about the smart design of one of the UK's most prestigious private schools that has recently opened in the UAE's capital, Cranleigh Abu Dhabi.

From futuristic elements to maintaining historical connections, the regeneration masterplan for Umm Qais (Gadara), a Jordanian town that relies heavily on tourism is revealed on page 26.

We also review Kuwait's stunning cultural hub, which is home to world-class performing arts and theatre productions, Sheikh Jaber Al Ahmad Cultural Centre. The design is inspired by Islamic architecture, with complex geometric shapes forming the outer realm, creating dramatic public indoor and outdoor spaces.

Africa's first proposed wooden tower is also featured, the award winning building will be constructed in Lagos using only timber and will offer a sustainable alternative to the concrete skyscrapers which currently dominate Nigeria's largest city. (Page 36)

As always we hear from our South American correspondent who profiles a Chilean project where naturally flowing water is at the heart of its design.

Enjoy the issue!

John Hampton

The opinions and views contained in the articles in this publication are those of the contributors and not necessarily of the publishers. The publishers cannot be held liable for any mistake or omission enclosed in the publication.

Managing Partner:
Ziad Maarouf Amine

Copy Editor:
John Hampton

Sales Manager:
Boushra Dinnawi

Administrative Assistance:
Sarry Gan

Art Director:
Ramon Andaya

Contributors:
**Jimena Martignoni, Ali Elewa,
Seejal Nagjee, Ken Campbell,
Dr. Anne Gharaibeh, Elaine Nettleton**

Printed by:
Al Nisr Publishing LLC

Webmaster:
www.pdinventive.com

For free subscription and to view the magazine please visit our website:

www.landscape-me.com

The First Specialised Landscape magazine in the Middle East

**Our magazine is available
in app store and google play,
search under Landscape
Middle East.**

Landscape is distributed free of charge in KSA, UAE, Qatar, Kuwait, Bahrain, Oman, Jordan, Egypt, and Lebanon by Emirates Post UAE

PUBLISHED BY:

MEMEDIA
Publishing

MEMedia Publishing FZ LLC
IMPZ

PO Box 485005, Dubai, UAE
Telephone: +971 4 4470927
Fax: +971 4 4470928



CONTENTS

February 2019 - Issue 140

- 16** Backyard Design
- 20** Sheikh Jaber Al Ahmad Cultural Centre
- 26** Cities of the Past
- 32** Prestigious British boarding school in Abu Dhabi set within village green on Sadiyaat Island
- 36** Lagos Wooden Tower stands tall
- 40** Egyptian Museum Extension at Cairo, Egypt
- 44** Sounds of running water





Panel discussion in progress at the 2018 edition of the Middle East Smart Landscape Summit

Building the city of tomorrow: Developing UAE's green infrastructure opportunities



MIDDLE EAST
SMART LANDSCAPE
SUMMIT 2019

United Arab Emirates, and Dubai in particular is known for its architecture, technological advancements and world-class attractions that make it a haven for its tourists and residents, alike. UAE's smart city initiatives and developments are in tandem with measures that promote sustainability. Dubai's landscape designed environments seen across the length and breadth of the city add a great deal to its character, complementing the skyline of towering skyscrapers.

In a bid to make UAE smart and sustainable, the city municipalities are at the forefront of implementing urban greening projects and have taken strategic measures to achieve this goal. Last month, Abu Dhabi City Municipality completed a major Dh5 million landscaping project along the roads in between Sheikh Zayed Bridge and Maqta Bridge, while, a few weeks back, Dubai Municipality introduced the world's first Smart Park, deploying a range of innovative services that prove to be a great benefit to the public.

UAE's sustainable infrastructure development strategy in protecting its natural resources, and transforming UAE into a verdant country ensures the improvement of urban aesthetics. In line with this vision, Abu Dhabi and Dubai aim to become walkable cities in the coming years, while the capital aims to complete the project by 2030, Dubai plans to be a walkable city by 2020.

Earlier this year, His Highness Sheikh Mohammad Bin Rashid Al Maktoum, Vice-President and Prime Minister of the UAE and Ruler of Dubai, launched the Marmoon Reserve – the largest natural desert reserve in this region, spanning 40 hectares of shrub land and fertile area.

To combat the environmental challenges many residents face in urban areas and maintain a blue-green urban infrastructure balance, there is a need to develop vegetated surfaces and increase the green quotient in cities. Apart from tackling environmental issues such as air pollution, reducing carbon emission and rain water management, enhancing a city's green quotient plays a crucial role in a resident's social life and overall wellbeing.

At the seventh edition of the Middle East Smart Landscape Summit, organized by Expotrade Global, over 450 senior landscaping professionals from across the region will come together to discuss the developments and trends in this industry. In line with Dubai's vision to transform the emirate into a smart and sustainable city, the two-agenda covers topics on embracing latest landscape trends into existing communities, emerging trends in landscape design, developing a green city in an arid region and the importance of increasing the green quotient in the city.

More information on the 7th Annual Middle East Smart Landscape Summit, being held on 18-19 March 2019 at Roda Al Bustan hotel, Dubai is now available at <http://www.landscapesummit.com>. Follow the Summit on social media with the hashtag #MELAND.

About Expotrade

Expotrade is a global conference and event organizer with its head office based in Melbourne, Australia and a regional office in Dubai, United Arab Emirates. Expotrade has delivered some of the largest, most successful B2B industry conferences and events. For almost 15 years, our unique blend of knowledge, experience and flexibility has accomplished an array of consistently top quality events. Today, Expotrade events enjoy such a distinctive edge, they are amongst the best patronized in the calendar. ■

Dewan Architects + Engineers has for the 10th consecutive year received top honours from the prestigious UK industry publication Building Design Magazine.

Dewan Architects Clinches a Spot in the Top 50 of World Architecture 100 “Big List”



“In order for our industry to thrive – especially when moving into new territories – architecture must be dexterous, compliant and, above all, imaginative. We believe that Dewan Architects + Engineers is amply fulfilling this brief, and it is always a good feeling when other industry professionals recognise this,” he added.

The Big List, which profiles the world’s largest architectural practices, is part of an annual survey commissioned by Building Design – a publication widely recognized as architects’ number one destination for news, comment and opinion of more than 2,000 firms worldwide, which are evaluated and ranked based on presence in the sector and region, as well as on the number of architects employed.

Every year Building Design (BD) surveys the world’s biggest architecture practices to create a report that is one of the most respected annual publications in the industry. Coming in at number 45, this is the second consecutive year that Dewan Architects + Engineers features in the top 50 of the list.

As one of the region’s leading architectural and engineering consulting firms, Dewan Architects + Engineers is recognised not only for being one of the largest architecture and engineering practises in the Middle East – with key markets in UAE, KSA and Iraq – but also for its extensive work in Europe and Africa, where it is working on hospitality and education projects including hotels for the Kempinski group in Ivory Coast and the Republic of Congo.

Speaking of the firm’s delight at once again making it to the top 50 of the list, Mohamed Al Assam, Founder and Chairman of Dewan Architects + Engineers – who recently scooped the the impressive seventh position on the Middle East Architect Power List 2019 – said: “We are thrilled to receive this recognition for our continued contribution to the architect and engineering industry both within the Middle East and further afield,” he said.

About Dewan Architects + Engineers

Celebrating 35 years of design excellence, Dewan Architects + Engineers has been at the forefront of the Middle East’s booming architectural and engineering design sector for more than three decades. Founder and current Chairman and Managing Director, Mohamed Al Assam, established the inaugural Dewan office in Abu Dhabi in 1984 and successfully completed Dewan’s first high-rise commercial project, Baniyas Tower, in 1988, which cemented Dewan’s presence as a major player in the regional architectural scene. In 1999, Dewan’s Dubai design studio was established, and it has rapidly become a prominent and integral contributor to the emirate’s burgeoning and iconic skyline. Dewan further entrenched its leadership market position by establishing new offices in Iraq, Kingdom of Saudi Arabia, Philippines, and Barcelona with plans to further establish offices in SE Asia and Africa. Today Dewan is recognized as a global multi-disciplinary practice, ranked as one of the top three firms regionally, and in the top 50 firms globally as rated by leading industry publications and its peers. ■

**Leading Manufacturer of Rubber Granules
for Sports and Recreational Surfaces**



»The quality for
outstanding
performances«

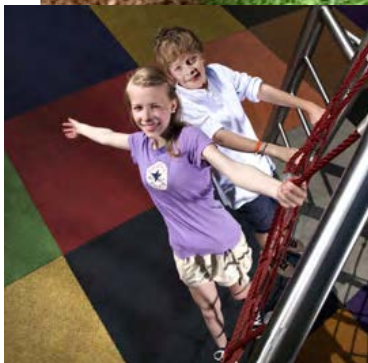

YOUR GAME OUR BUSINESS

Dubai +971 4 3391331, P. O. Box 37164
office@raymondsport.com

Abu Dhabi +971 2 4499196, P. O. Box 73076
www.raymondsport.com

HEI Solar Light Columns LUKIDA

Introduction of renewable energies and the increase of energy efficiency

Global warming and scarce resources necessitate an eco-social reorientation and a phase-out of fossil energy sources and risk technologies. HEI's vision is an ecologically, economically and socially sustainable energy supply. With our work, HEI would like to contribute to the introduction of renewable energies and the increase of energy efficiency. We are striving to accomplish this through the development of innovative technologies and products. In doing so, HEI is endeavouring to create new areas of application for renewable energies while lowering costs to make them competitive. Since the foundation of the company in 2001, HEI has evolved into a global leader in providing highly efficient solar lighting products.

We know, that we can provide our client with the best products only by combining high technology, reliability and excellent design. Utmost efficiency, solar energy, minimal ecological footprint and highest quality for long life-span make HEI's product uncompromisingly environmentally friendly. Moreover, our products are designed and manufactured in the hearth of Europe, in Austria, where high technology is combined with long-time experience in order to provide outstanding quality and reliability for long life-span.

In desert regions, such as the Arabian Peninsula, flat PV panels must be cleaned every four to six weeks and after every sand storm. Despite low labour costs in these regions, this causes significant maintenance costs. Moreover, parking trucks for cleaning on street are a safety risk and can cause congestions. HEI produces vertically integrated, cylindrically shaped, patented photovoltaic elements, called HEI Power tube, for its solar lighting systems. This means, that there are virtually no costs associated with cleaning the panels. More than that, they produce much lower wind loads and are also safe against theft.

The straightforward forms and the aesthetics of HEI light poles are perfect for modern, quality architecture in the public and private environment. The modular design of solar lights allows for adaptations in design as well as in functionality. This has been recognised in the past, when HEI was awarded numerous design and technology prizes, among others with Austrian design award and our product HEI Champ being part of the permanent collection in Austrian museum of design in Vienna. We are grateful, that also the jury at BIG5 Landscaping expo also recognized our new product range HEI Solar Light Columns LUKIDA and awarded us with the Innovative Product Award.

HEI Solar Light Columns LUKIDA are a family of aesthetic Solar Light Columns with integrated photovoltaics and luminaire for decorative private or public solar outdoor lighting applications, such as gardens, parks, boulevards, and secondary roads.

HEI's products are all about combining high technology and top design



standards, with the aim of providing significant cost savings for our clients. Mechanical engineers, designers and architects worked together to provide a highly efficient, self-sustaining solar light column, without a compromise on the aesthetics of the product. Clean lines, smooth mechanical connections and above all, perfect performance, strengthen the leading design idea of the LUKIDA – solar light column, when aesthetics matters.

Thanks to the modular HEI Power Tube system, Solar Light Columns LUKIDA achieve different lengths of autonomy, adjustable to client's needs and wishes. Vertically Integrated Cylindrical Photovoltaics – HEI Power Tube, a patented solution of HEI technology International, is a modular system of pole-integrated solar elements. Different diameters of the tube provide a lot of design freedom and by simply stacking the HEI Power Tubes, the system can be modified to client's needs.

Seamless pole integration of solar elements (vertically integrated cylindrical photovoltaics) and pole-integrated luminaire gives us freedom to configure highly-efficient LED engines to circular or lengthwise aligned light distribution, covering a wide range of outdoor lighting applications. Because of uniquely vertically aligned solar elements and by using scratch-resistant borosilicate glass for encapsulation, HEI Power Tubes minimize snow, dirt and sand deposits, making the system maintenance-free.

By using only the best, highly-efficient LED engines, HEI's team was faced with the challenge of transferring heat from the luminaire. This was solved with an innovative, self-cooling design of the luminaire, which greatly contributes to the long life of all HEI Solar Light Column LUKIDA products.

By integrating HEI Power Tube and luminaire with the pole, the HEI Solar Light Columns LUKIDA are the perfect solution, when there is a need for a reliable, high-tech solar product, that complements architectural, urban or landscaping project.

HEI Solar Light Columns LUKIDA are customizable with a wide range of smart-city accessories, from CCTV, wi-fi hotspots, speakers, sensors ... compatible with all major smart-city protocols and monitoring solutions. HEI Solar Light Columns LUKIDA are more expensive than conventional, grid-powered columns, but save installation costs. At outdoor lighting applications, the power supply of the light poles is often much more expensive than the pole/column as such. HEI Solar Light Columns LUKIDA are complete solar powered, self-sustaining solutions and don't require power supply by the electricity grid. No earth work, trenching, cabling and surface restoration is required, which saves significant costs. Compared to conventional electricity grid-powered poles and columns, HEI Solar Light Columns LUKIDA are therefore often the much cheaper choice. ■



OUR COMMITMENT

Return to nature the best of what nature gives us.

100% NATURAL PINE BARK

PINE BARK ADVANTAGES

- **100% natural** pine bark made in Portugal.
- **Free** from pathogenic microorganisms, fungi and weed seeds.
- Our pine bark **retain soil moisture**, reducing the frequency of watering and reducing water consumption.
- **Protects** roots from frost and excessive heat.
- **Regulates the PH of the soil** by improving the quality of plants.
- Its **decorative element** highlights the green grass and colours in the flowers.



Distributed by



TANSEEQ

📍 Tanseeq L.L.C, P.O. Box 28665, Dubai, U.A.E.

☎ 971 (04) 3617199 📠 971 (04) 3607966

🌐 www.tanseeqllc.com ✉ info@tanseeqllc.com

NEWS & EVENTS

Award-winning AUS architecture graduate Ibrahim Ibrahim has been announced as the inaugural recipient of the Emaar CAAD Labs Fellowship by the College of Architecture, Art and Design (CAAD) at American University of Sharjah (AUS).



AUS announces recipient of inaugural Emaar CAAD Labs Fellowship

The Emaar CAAD Labs Fellowship is made possible through the generosity of Emaar Properties, the global developer, and provides an exceptional graduate of CAAD the opportunity to spend one academic year advancing their work in the context of CAAD Labs and benefitting through engagement with faculty and students.

Newly appointed recipient Ibrahim Ibrahim is a Lebanese architect who was born and raised in the UAE. During his senior year at AUS, Ibrahim received the Sheikh Khalifa Scholarship, as well as the Dean's award for highest academic achievement, and graduated magna cum laude with a Bachelor of Architecture from CAAD—the region's most prestigious architecture and design institution.

Recognized within the professional community as an up and coming young architect in the Middle East, Ibrahim has already built an impressive portfolio working with architecture firms in Los Angeles, Madrid and Dubai, and was awarded first place in the architecture category of the Sheikh Manal Young Artist Award in 2017.

As the Emaar CAAD Labs Fellow, Ibrahim is dedicating at least 30 hours a week to the development of his proposed project for the entire academic year (a period of nine months), which will ultimately culminate in a public lecture and an exhibition of the work at the end of the Spring 2019 semester.

In addition, Ibrahim also provides workshops to share his expertise with undergraduate architecture and design students

undertaking the same program from which he recently graduated.

"I am very excited to be back at AUS where I can contribute to its focus and ongoing research on reconsidering the future of our built environment," Ibrahim said.

The Emaar CAAD Labs Fellowship allows Ibrahim to pursue his interests in experimenting with structure and form to explore new ways of experiencing space in architectural design.

"Other areas that interest me for my future research stem from my goal of developing improved spaces that move parallel with today's advancement in technology. I'm interested in creating complex experiential spaces through computer-aided techniques and cutting-edge technologies," said Ibrahim.

Besides the physical outcome of the fellowship, Ibrahim is confident that the fellowship will be the guiding ground for him to set his own practice in the near future.

"I am excited to share and continue to explore a working research methodology and collaborate with local industries to produce work that is relevant to our region," he said.

Ahmad Al Matrooshi, Managing Director of Emaar Properties, said: "The Emaar CAAD Labs Fellowship aims to nurture the next generation of talent in design and architecture. It highlights our commitment to building a talent pool of young and dynamic professionals, who will help in shaping the next generation of smart city developments that add to the pride of our nation."

During his fellowship, Ibrahim is supervised by Ammar Kalo, Assistant Professor and Director of CAAD Labs, who is also a designer and architect.

"Ibrahim is an excellent designer and he's already familiar with our labs, so my job as his mentor is to take a step back and give him the space to work on his project, as well as to provide critical and technical feedback. Ibrahim is the ideal candidate for fellowship, and I'm excited to see what he'll produce over the coming months," said Kalo. ■



40Years in
BUSINESS

QATAR | LEBANON | UAE



A MEMORABLE WATER SHOW

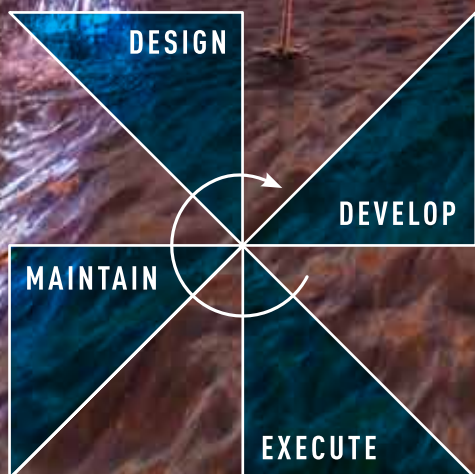

**SPECIALIZED TURNKEY
SOLUTION PROVIDER**



Member of
AL MIYAN
HOLDINGS GROUP

f i watermaster.me



www.watermaster.me

Katara Amphitheater, Qatar



Championship golf course in UAE first in the region to promote sustainable lighting

Ethihad ESCO to retrofit 18-hole golf course with LED lights for Dubai Golf & gain up to 60 per cent from energy savings

UAE, 21 January, 2019 - Etihad Energy Service Company (Etihad ESCO), a wholly-owned subsidiary of DEWA, has partnered with Abacus Lighting to fully retrofit Dubai Golf's 18-hole golf course located in Dubai to replace its existing metal halide solution with LED lighting. The new sustainable lighting system is set to improve the overall quality of light across the golf course, covering a total area of approximate 6.08 Million Sq. Feet and bring up to 60 per cent energy savings for the company.

The championship golf course is the first in the region that has moved to LED lighting technology with the installation to be done in an efficient manner featuring a base-hinged system during the replacement of floodlights to ensure the greens and fairways are well maintained and plays are not disrupted. It will use one of the lightest high-performance LED floodlights in the market, weighing only 22 kilograms, including an integrated driver. The lighting system is expected to give light to the course for up to 15 years.

Ali Al Jassim, CEO, Etihad ESCO, said: "Luxury leisure and recreation venues in Dubai could be high energy consuming and moving towards an environmentally-friendly approach to providing such facilities in Dubai is testament to the increasing awareness towards energy sustainability in the UAE."

He added: "Our strategic agreement with Dubai Golf to implement the first LED lighting retrofit in a golf course in the region is a welcome move that shows leadership in promoting energy efficiency and we commend the company for taking this important step. This partnership further supports the Emirate's efforts to achieve 30 per cent reduction in energy

consumption by 2030 and brings us another step closer towards meeting our sustainability goals."

Abacus Lighting, which will install the LED lights, has been working for more than a year to create multiple design options that will ensure the project will be implemented with the optimum solution in line with Dubai Golf's requirements, primarily considering the quality of light, energy consumption and ease of implementation. The advanced technologies to be used in the retrofitting project also promotes Dubai's efforts to tap technological innovation in line with the Smart Dubai 2021 strategy, as the installation process is designed to be unobtrusive to players' golfing experience any time of the day or night.

Christopher May, CEO, Dubai Golf, commented: "Dubai Golf places huge importance to golfers' playing experience especially at night and we maintain the highest standards for the championship golf course which has been hosting many international tournaments. It is only fitting that we shift to a more ecologically sustainable lighting system and we are excited to be the first in the region to have a LED-lit 18-hole golf course that also contributes to attaining Dubai's vision to become a truly sustainable city."

Retrofitting buildings and facilities with LED lighting technologies is a major energy efficiency initiative that can help significantly save energy by up to 50 per cent. Etihad ESCO has been proactively promoting and helping organizations in the UAE to achieve their sustainability goals through auditing and designing energy conservation measures. ■



POLYSOFT

FLEXIBLE SEAMLESS PAVING



Redefining Excellence in Aquatic Surfacing and Playground Surfacing



Distributor and Authorised Installer:



Tanseeq LLC, PO Box: 28665, Dubai UAE
T +971 4 3617199 F+971 4 3607966
info@tanseeqllc.com www.tanseeqllc.com



BDP JOINS FORCES WITH LEADING CANADIAN PRACTICE

Leading UK and Canadian architectural practices form partnership to create a platform for broadened international growth and expertise

BDP has made a strategic investment in Toronto-based Quadrangle, one of Canada's most respected architecture and interior design practices. The partnership will create a platform for continued international growth in key markets and sectors across Canada and North America.

John McManus, Chief Executive of BDP says: "Quadrangle supports our strategy to grow operations in the Canadian marketplace and greatly enhances our expertise and resources. The addition of a 200-strong studio in one of North America's largest cities will not only provide exceptional opportunities for our people, it will also enable both BDP and Quadrangle to expand our services into new regions. BDP's collective grouping of professions design with a progressive outlook and a sensibility towards the creation of a sustainable and human environment. We are confident that our culture and ethos will be greatly enhanced by the addition of Quadrangle. We are also delighted to welcome four of Quadrangle's Principals to the BDP Group Board."

Quadrangle Executive Principal, Anna Madeira, says: "We are incredibly excited to join BDP. This partnership infuses our business with greater expertise, services and resources that we can offer to our clients, and it enables us to provide our staff with increased opportunities to work on diverse projects."

Founded in 1986, Quadrangle is an architecture and interior design firm renowned for its client service resulting in long-term relationships. The firm's portfolio spans the commercial, mixed-use, multi-unit residential, content media and retail markets, and includes specialisations in areas such as masterplanning, accessibility, sustainability and adaptive re-use. Quadrangle's office of over 200 architects, interior

designers, technologists and support staff will continue to operate under the Quadrangle brand and under the direction of Quadrangle's principals.

"Our firms share common values — that design begins with people, and great architecture and interiors are accomplished by developing close working relationships with clients and stakeholders. Both companies are passionate about the role of design to improve everyday life," comments BDP Chair Chris Harding.

"BDP is a natural fit with Quadrangle," adds Quadrangle Executive Principal Richard Witt, "We enjoy a similar collaborative, supportive, culture and passion for design excellence as a means of creating better cities. We are confident that this union will build on our separate accomplishments and establish a shared platform for even greater things, together."

Quadrangle is currently completing the Yonge-Sheppard Centre, a large mixed-use development in North Toronto; 80 Atlantic Avenue, Toronto's first wood office building in over one hundred years; and Downtown Markham, a large scale mixed use development featuring retail, housing, office and hospitality in a progressive urban setting.

BDP is currently providing full inter-disciplinary design services to restore and safeguard the future of the Palace of Westminster, the seat of the United Kingdom's parliament. In Toronto, BDP has designed a three-level retail podium for RioCan at The Well - a large mixed-use commercial development, currently under construction.

BDP is the 30th largest practice in the world with 378 qualified architects according to BD's World Architecture 100 league table. Quadrangle is at position 94 with 110 qualified architects. ■



W Dubai- The Palm



Kite Beach- Dubai



New Sharjah Municipality



Dubai Safari Park

Creativity. Quality. Sustainability

Consent presents a perfect platform for Landscape Designers to create and bring their designs to reality. With a wide range of products covering Concrete Pavers, Boardwalk system, Retaining wall systems, Street furniture and several other innovative products, we provide a one stop solution for your requirements.

We work hard today to shape a greener tomorrow

*Versatility
&
Innovation
at its best*

For more details or technical support,
Please Contact : sales@consent.ae
Landline : +971 43472011 or
visit www.consentblock.com



Providing Concrete
Solutions Since 1975

Losberger De Boer wins build contract for Saudi Arabian Falconry Club

Global temporary building specialist, Losberger De Boer, has secured the temporary structure build contract for a next generation Falconry Club to be constructed near Riyadh in Saudi Arabia.



The complex will comprise 1,800sqm of interior space using Losberger De Boer's Palas Double Decker modular building product, featuring a high quality VIP interior fitout together with mezzanine floors and lifts.

Work began this month and was completed in 17 days, with the contract awarded for an undisclosed sum. This contract win comes only six months after Losberger De Boer was awarded the build contract covering the entire temporary structure for the world's largest camel festival held in the Taif desert near Riyadh. A unique feature of the project was the 30 x 25m temporary building that had to be built in only eight days. Losberger De Boer delivered on deadline and the event was subsequently awarded the largest sporting event of its type globally, by Guinness World Records.

Jim Muldoon, Managing Director at Losberger De Boer Middle East said: "We are becoming increasingly known for our rapid build times and range of 70 different modular building types, which have the look and feel of permanent buildings. We have forged a strong niche market in the mega-events space as well as for delivering high specification

temporary buildings for projects where ISO-certification and premium build quality credentials are important.

"Crucially, it's all about providing an unrivalled visitor experience for guests and building users and our teams work hard to ensure these high quality structures are erected safely and in record quick time, while keeping disruption to surrounding businesses or residents to a minimum. In recent years, Losberger De Boer has emerged as the preferred partner for Middle Eastern businesses wanting to accelerate new business openings, or events managers needing to stage major events at short notice. It follows that we are seeing our client base substantially grow as we move towards Dubai Expo 2020 and as Saudi Vision 2030 advances," concluded Muldoon.

With close to 700 projects delivered globally every year, Losberger De Boer also built the Middle East's largest temporary exhibition hall, Bay X at King Abdullah Economic City in Saudi Arabia and the initial 15 temporary buildings for the Qiddiya Entertainment Resort which forms a critical part of the Saudi Government's Vision 2030 economic transformation initiative. ■

AustraBlend®

Multi Mineral Root Zone Conditioner

Turning Desert Sand into Arable Soil...

Maximizing the use of AustraBlend® Multi Mineral Root Zone Conditioner

The product was developed with the objective of treating high production agricultural land, landscapes of all dimensions and the soil of sports and playing fields specifically lacking in highly nutrient activated water absorbing clays. At recommended application rates, we have achieved this objective with once only applications to maximize production rates in the shortest time frame at the maximum productive life span.

Applications of AustraBlend® Multi Mineral Root Zone Conditioner are intended to increase soil yield potential immediately as well as to increase soil fertility in the short to medium term.

Our research has demonstrated that in sandy soils this objective is achieved with a once only application of <>5 – 10% by volume incorporated into the soil at depths of 150 – 200 mm.

Substantially increased water holding capacity (WHC)

Increased nutrient adsorption and recycling leading to significantly increased CEC and controlled Buffering Capacity levels at recommended application rates.

- Permanent improvement to the total soil structure.
- Improved aeration and exchange of soil gasses.
- Consequent increased natural biological soil health.



Al Habtoor Polo Fields Dubai – Commenced June 2015,
completed and ready to play December 2015.
Stolonised Bermuda 419 – Grown to perfection with 10L/m² per day!

Immense Water Savings

ICBA (Dubai) Trial Data

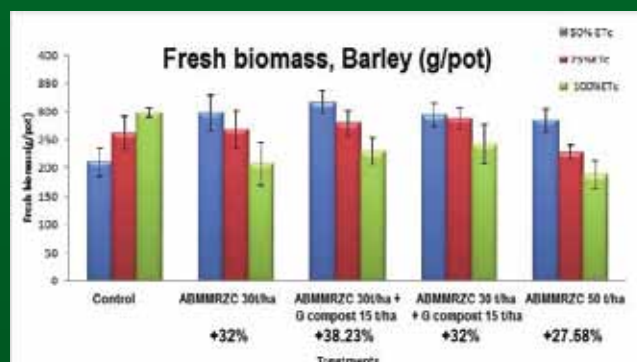

ICBA International

AustraBlend®

DISTRIBUTOR

Polyclean LLC, Dubai UAE Tel: 971 050 635 9026

GARDEN



By: Sejal Nagjee

Backyard DESIGN

Inside a chic, contemporary garden in
Mohammed Bin Rashid City villas





Dubai is bursting with plush villas and picturesque communities. Mohammed Bin Rashid City villas by Sobha developers is another stand out project, where I was fortunate enough to landscape a five-bedroom contemporary villa for a Gujarati Indian family who wanted a contemporary look for their landscaping. The architecture of the property is very linear, simple, modern and plain with large glass windows, high ceilings, white façade paint and metal brown louvered grills. The entrance has high glass beside the main door, the pathway leads to the backyard that has a spacious landscaping area (plot size is 10,000 sq. feet and the development area for the landscape was 635 square meters).

Garden design

The client was looking for a low maintenance, spacious, clutter free garden with a unique shade structure, features on walls, a buffet counter, and usable space. Their main criteria were to keep it simple and cozy and make it very easy for them to look after. A “No fuss” garden!

It is very important to complement the architecture, color and form of the façade of the property. We designed a simple linear design, keeping the areas free flowing, easy to walk, clean and maintain. Outdoor porcelain was combined with Silver Travertine in borders in the front and right-side pathway. As you turned right, you would face a lovely metal panel flanked with stone clad walls and nice wall light.

GARDEN





Long pathways can be monotonous to walk on so we made a pedestal with different heights with a background of wooden vertical rafters to place pots. We fixed a Buddha statue panel on the wall. It was a perfect way to create a serene pathway.

Fauna

The backyard has a beautiful white pergola with a water proof roof that would protect the furniture below from moisture drops, rain and dust. Concrete seating was made with a standard depth and outdoor UV resistant, water repellent fabric seating and back rest cushions were used to make the seating comfortable. Colorful 40x40 cms throw cushions made the seating inviting and colorful. The pergola had a candle wall which can be put on with one switch and creates a very harmonious and serene ambience. A nice beaten steel metal table was placed in the center.

The flooring had linear strips of black absolute flamed granite inserted in between outdoor porcelain

tiles. All of the colors are neutral – grey, white, black, brown, beige as well as the colors projected from cushions, surrounding plants, artificial green grass and a dash of turquoise in the feature wall.

The feature wall at the rear is my favorite piece! The firepot which is fueled by a gas cylinder is the centerpiece of the garden. It's on a pedestal flanked by two feature walls. The circular metal halves have liquified metal finish in rust and blue tones. There is also a hammock to relax on the grass, customized in our in-house carpentry factory.

Since the client wanted an easy to maintain garden, we restricted the grass area. However, there are still plenty of greenery. Horizontal greenery including the grass and ground cover plants and vertical greenery, including tall and short bushes and creepers. It is always possible to keep a balance between hardscape and softscape and play around with different proportions of greenery. A ratio of 70 % hardscape to 30 % softscape is ideal as it's easy to maintain and restricts the use of water and electricity.

We used a variety of different trees, including plumeria, Cassia Fistula, Bauhinia, Lemon, Pomegranate, Mango, Drumstick (Moringa) and Curry Patta which had the perfect ambience for a home grown garden. Lush green perennial plants were also used; Thivetia, Taebernaemontana, Murraya jasmine, Jasmine Sambac, Jetropha, Basil, Bougainvillea, to name a few. This resulted in a naturally fragrant garden with very sturdy plants. An automated irrigation system ensures the plants are kept healthy.

Lighting

The most important part of the landscape is the lighting. Entrance, pathways and steps were nicely lit to create a safe entry and a well-lit passage. Use of subtle in ground lights of low 1.2 wattage were used. Concealed led strip lights were used in the raised planter box top coping to highlight the stone cladding and light up the area indirectly. Up and down lights were used to highlight the pergola columns and walls. Spot lights highlighted the area within the pergola. Ambient mood lighting was created by the candle lanterns in the pergola. Fauna were highlighted by 8.5 watts and 4.5 watts 12-volt ground spike lights. The entire garden had its own feature, essential and mood lights. The garden is well -lit at night making it the perfect location to host parties and family gatherings.

Overall, the client's garden is a well-designed architecturally balanced and harmonious space that complements the façade and brings the interiors out into the landscape. It's an extension of the owner's personality! ■

I LANDMARKS

Launched to glorious fanfare in October 2016, the Sheikh Jaber Al Ahmad Cultural Centre (JACC) is a dazzling showcase for the performing arts and world-class theatre quarter set within spacious parkland. Forming part of Kuwait's new national cultural district, the bold, forward-thinking design of JACC has made it an iconic architectural landmark, forever changing the capital city's skyline.

Kuwait's Cultural Hub
shines bright:

Sheikh Jaber Al Ahmad Cultural Centre

The cultural centre includes state-of-the-art theatres, concert halls, cinemas, conference and exhibition halls and a library archive. The four buildings are accessed from spacious entrance courtyards and sit like shining, faceted jewels within a larger public park. The key buildings of the complex are the Theatre Centre, Music Centre, Conference Centre, and National Library for Historical Documents,

all set within a National Park for Kuwait. JACC regularly attracts leading global performers and shows, such as CATS the musical, Sting, and the London Symphony Orchestra, as well as cultural favourites from Kuwait and the MENA region. It also acts as a springboard for new, home-grown talent and serves as a major national and international focal point for the arts.

The Vision:

The Amiri Diwan's vision behind the centre was inspired by the desire to explore the heritage of Kuwait, experience and build on the Kuwait of today, and imagine its future, while also creating a leading social and creative hub for Kuwait and the MENA region. The mission was to provide a world-class stage for international and local musical, cinematic, theatrical and operatic performances within a landmark design.

The client's brief was also to create a signature design that would punctuate the skyline of Kuwait for generations to come. The ambition was to create a new architectural reference for the Middle East, with technical and multifunctional theatres to establish it as one of the state-of-the-art performance venues for the world. Ultimately, the aim was to offer residents and visitors of Kuwait City a destination for performing arts, music and conferences.

The Concept:

SSH's design for the JACC complex was inspired by Islamic architecture, with complex geometric shapes forming the richly textured outer skin, creating dramatic public spaces inside and out. The wonders would continue within each of the buildings, where visitors find jewels within jewels as they explore the beautifully designed, luxurious interiors of these world-class buildings.

The client's brief given to our Interior Design team was to create "a jewel within a jewel". SSH interpreted the interior design brief to be one of rich layers of internal cladding that develops in richness as you enter the foyers, and that increases in intensity and texture as it flows into the performance spaces. Each building has a unique colour scheme that complements its function, but they all share the same design approach.



I LANDMARKS



The Elements:

Several key design elements, with other innovations in structure, materials, sustainability, safety and security, come together in a functional complex, marrying Islamic architectural cues with futuristic design. As such, JACC is the centrepiece of Kuwait's national cultural district. These elements are:

National Park and Courtyards - Set within a landscaped oasis, JACC juxtaposes its futuristic architecture against its peaceful surrounds. The courtyards provide dramatic entryways into the buildings with an intuitive use of hard and soft landscaping that blends harmoniously with the stunning façades. Meanwhile, the park provides areas of shade, aesthetic pathways and tranquil water features that complement the crystalline building design.

Steel Structure - JACC's buildings are each covered by a steel skeleton encased in a titanium and glass skin that captures light and sparkles. This projects the stunning Islamic pattern that creates the outer shell of the buildings. Each shell not only provides a climatic protective envelope for the buildings within, but also creates dramatic interior public spaces.

Signature Chandelier - A monolithic signature chandelier drops a striking 14.5 m, illuminating the National Theatre's foyer with almost 220,000 LEDs. This tiered 20-ton array of cascading glass evokes an indoor waterfall that visitors can walk around, pass under or walk behind.

Calligraphy - The complex's pavilions feature more than 8,000 sqm of bespoke, decorative calligraphy designed into the cladding of the theatres, concert halls and libraries. Seven stanzas of His Highness Sheikh Jaber Al Ahmad Al Sabah's sayings promoting culture and development were selected by the Amiri Diwan to apply to the theatre and music centres.

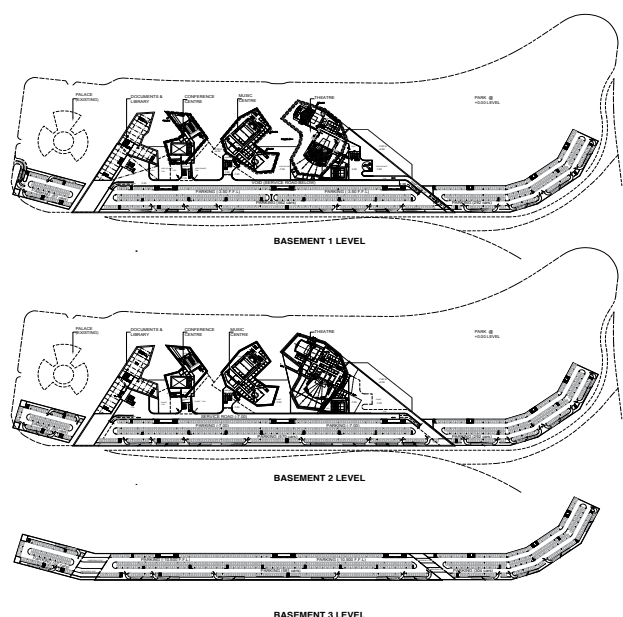



The Performance Spaces:

SSH worked closely with theatre engineers and acoustic specialists to create multiple performance spaces that are sophisticated in design and engineering. The interior design of these spaces complements their function and are intended to capture the soul of each performance while engaging the audience.

The Theatre Centre:

T1 National Theatre

(2,000 Seats)

This space has variable acoustics designed for musical theatre and speech-based drama as well as amplified opera performances. The balcony fronts and overhead reflectors have been angled to maximise sound reflections to the rear of the auditorium to help provide an immersive experience for all the audience.

T2 Drama Theatre

(700 Seats)

This has fixed acoustics and is designed for speech-based performance and musical theatre. Shaping of balustrades and overhead reflectors has been used to assist sound reflections to seats at the rear of the auditorium. The auditorium envelope has been designed to provide high-level sound insulation with lobbied doors throughout.

T3 Studio Theatre

(150 Seats)

A raw rehearsal space, variable acoustic drapes behind metal mesh allow for flexible space designed to accommodate different performances that vary in acoustical requirements.



LANDMARKS



The Music Centre:

M1 Symphonic Concert Hall
(1,500 Seats)

This is a symphonic concert hall with variable acoustics provided using hidden acoustic banners and inflatable baffles. When banners and baffles are retracted, the hall is designed for orchestral music. The stage has mechanical stage risers with a solid timber platform to act as a sounding board for orchestras. Acoustic banners and baffles can be employed to provide conditions suitable for jazz or big-band performances.

M2 Recital Hall
(350 Seats)

This is a recital hall with variable acoustics, also employing acoustic banners. When banners and baffles are retracted, the hall is designed for chamber music. Banners employed provide conditions suitable for small jazz ensembles and acoustic folk music. The hall is designed to provide an 'in-the-round' experience, where audience members are close to performers.



The Conference Centre:

C1 Multipurpose Hall

The flexible multifunction hall can be fitted out in the following configurations:

- Conference Configuration (Flat Floor): 540 Seats
- Theatre Configuration (Tiered): 540 Seats
- Classroom Configuration: 140 Seats
- Banquet Configuration: 240 Seats
- Cabaret Configuration: 120 Seats
- Exhibition Configuration: 540 Seats



Acoustically, the Multipurpose Hall has a sound absorbent treatment on the walls and ceiling suitable for large conferences and functions with speech reinforcement and amplified music. Foldable fixed seats on lift wagons can rise on guiding rails integrated within the wall finish to transform the flat floor space to tiered theatre seating.

C2 Symposium
(80 Seats)

This is designed for seminars and lectures with speech reinforcement. The seating also retracts to provide a flat-floor studio space.

C3 Cinema
(400 Seats)

The acoustic treatment applied to the walls and ceiling, along with carpeted floors, provides a 'dead' auditory space suitable for film soundtracks. A podium stage is also provided to allow the space to be used for lectures with speech reinforcement. ■

Cities of the Past

Umm Qais (Gadara) Comes Back to Life



Figure 1

Master plan prepared by:
Dr. Anne Gharaibeh, Maha Ababneh, Dana Zuraiki, Sara Al-Arabi,
Sameera Al-Dabbagh, and Haifa Khnefes

Department of City Planning and Design
College of Architecture and Design
Jordan University of Science and Technology

Umm Qais also known as Gadara, witnessed many urban transformations throughout its history. An extremely fertile rural area populated from ancient times in the North of Jordan. Its population continued to settle in this unique and strategic place until this day. The local population continued their existence despite the ruling and political administration. From ancient, to Greek to Roman (member of the ten cities of the Decapolis), to Hellenistic, to Umayyad time, into the Ottoman time, and until today. Its rural population were integrated in this city; however, it's having some socio-economic difficulties despite all the efforts made to enhance its status as a tourist destination. The significance is based on its location floating on a hilltop 378 meters above sea level overlooking Galilee Sea at 209 meters below sea level, the Golan heights, Yarmouk River Valley, and Jordan River Valley (209-430m

below sea level) (Figure 1). It is surrounded by agricultural fields and a major natural reserve called Yarmouk Reserve. Locals work in producing agricultural and dairy products, as well as other food production. While, one third of its population work in governmental institutions outside the city. However, large numbers of locals are unemployed (around 33%).

The integration of the residents with the local economy is very limited due to the urban expansion and the changes in the urban morphology, which has created vast distances between local settlements and the major touristic activities. Despite some adaptive reuse projects, the administration of tourism in the area is ineffective, having failed to integrate tourists with the local culture and economy. This has resulted in the shortening of the length of time that tourists stay in Umm Qais.

The regeneration project therefore had to consider many factors before proposing an urban renewal project in the area to focus on creating job opportunities, encouraging tourists to spend more time in the area and providing new recreational uses, as well as marketing local goods, and enhancing the economy and urban morphology. It also focused on re-integrating the locals with the distinguished location and its economic potential. The strategy exceeds the traditional keeping of heritage and archaeological sites to the maintenance and the re-use of heritage sites; proposing new activities in the landscape; proposing interventions that have the capacity for reviving the place and integrating the locals with the tourists. The city is divided into zones going back to different times (Figure 2)

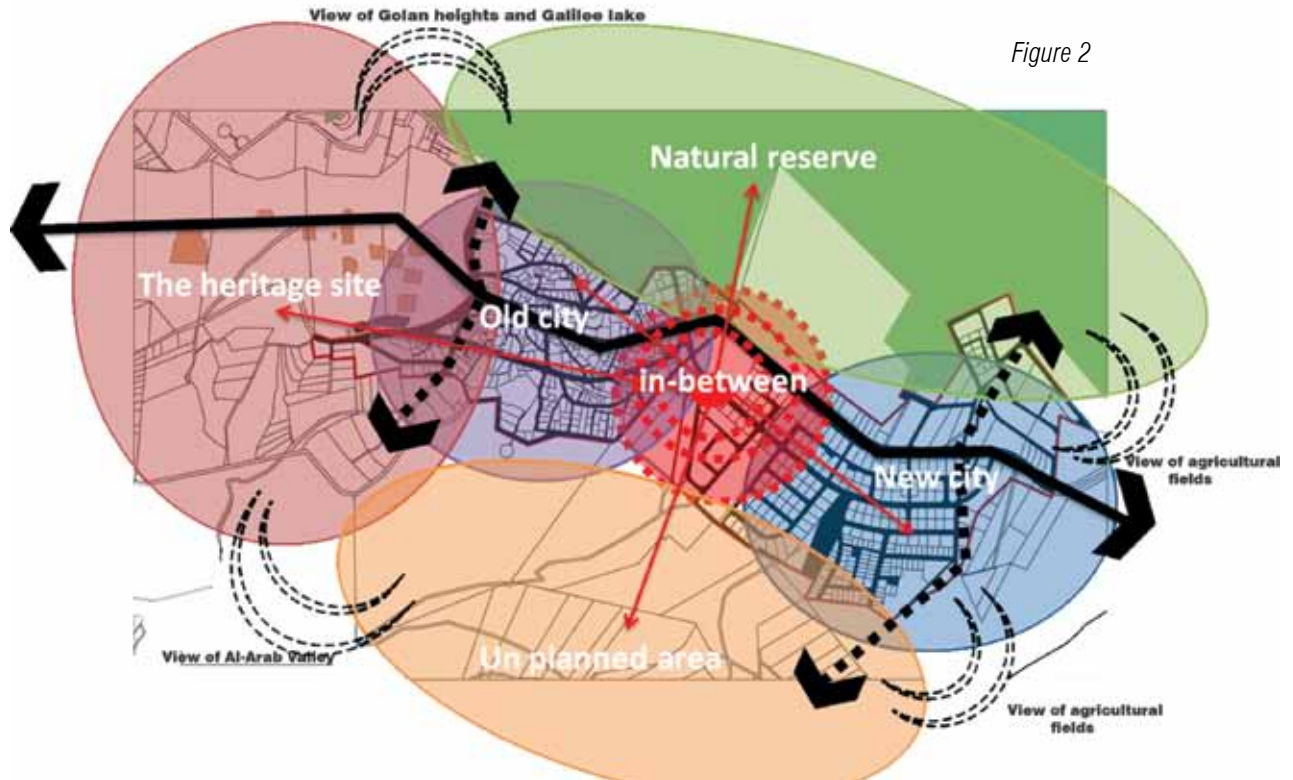
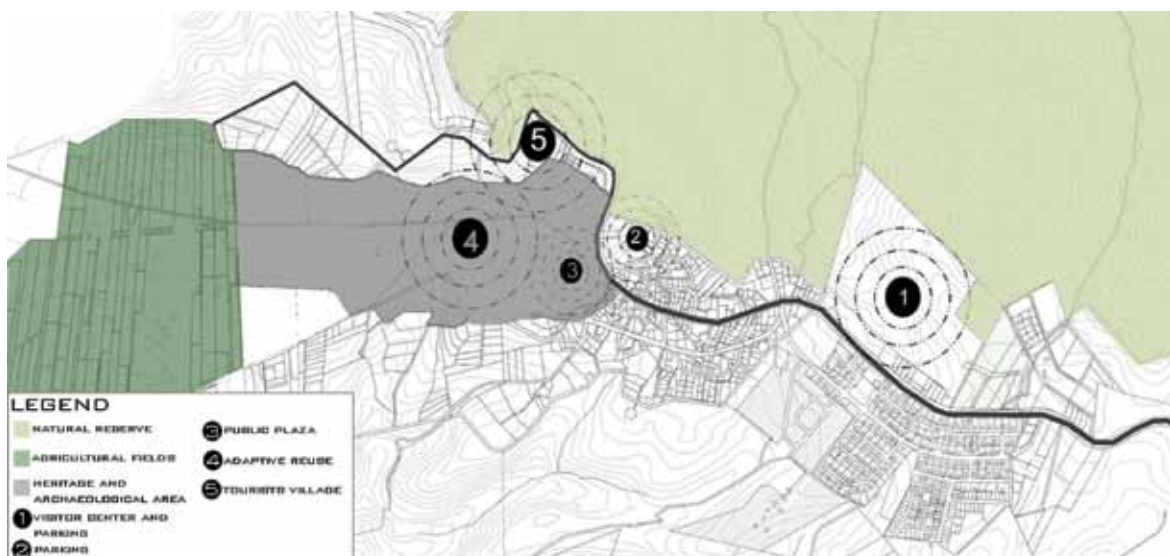

Figure 2

Interventions

The interventions are focused on sustainable urban renewal solutions and they can be summarized in many different interventions (Figure 3):

Figure 3



After visiting the heritage site with the many galleries and cafes adapted to the over 100 year old houses, they can reach the Greco-Roman site with its theaters, temple, shops, and streets (Cardo and Decumanus) (Figure 4&6). From the site, they can overlook the historic Golan Heights, the Galilee Sea, and Jordan Valley. The extension of the greenway at the edge

of the slope takes them to the home stay pods and recreational facilities along the plateau which boasts similar views (Figures 6, 7, 9).

The recreational facilities include restaurants, an outdoor theater, swimming pools and kids play areas adapted to meet family requirements.



Figure 4



Figure 9



Figure 7

MASTER PLAN

The Plaza

The plaza is a key place linking the contemporary city with the archeological and heritage sites. It acts as an effective instrument for social cohesion. It is also the entrance for the place where security checks take place (Figure 8).



The Archeological and Heritage sites

The heritage site of Umm Qais represents important historical activities, which have been adapted for present day uses such as cafes, galleries, overnight accommodation, and many courtyard activities. The archeological site includes theatrical performances representing ancient Greek and Roman life, as well as shops from ancient Greek time that have been renovated and reused as galleries for local products. Local products include olive oil, dairy products, honey, embroideries, and traditional clothes.

The Bus Line and the Greenway

A great potential to connect the heritage site in Umm Qais within a good network that serves the whole site of Umm Qais and its fields, suitable for both residents and tourists. The concept is to build a bus route with relatively low fees to encourage people to use public transportation and minimize the traffic, to fulfill our next step to create a walkable layout for the area which has a lot of benefits (Figure 9).



Figure 9

The greenway runs all through the city from the visitor center to the end of the plateau. Its tracks lead to the natural reserve, to the home stay pods, to the recreational areas and to all attractions in general. It serves all kinds of activities with a bicycle lane, trees, and pavement suitable for all kinds of users.

The Home Stay Pods and the Recreational Village

Tourists can enjoy plentiful views while staying overnight, including sunset views overlooking the Jordan valley. Hot spring mineral waters can be brought from the valley below to be used in the Jacuzzis of the private pods. The home stay pods will be designed to come along the topographical nature of the relatively steep slopes and the presence of the nature and trees in between these lodges making it a natural and great experience.

This village provides great recreational facilities for locals and visitors alike, including traditional cafes suitable for the whole family to enjoy together. Tourists can continue to explore the nature and the different types of trees and explore some light sport activities.

This design will bring Umm Qais to life by providing more job opportunities, more active tourism, and longer tourist stays. It will render the place successful as a distinguished destination. Visitor numbers are expected to double and the number of overnight stays are expected to rise from zero to at least 300 people.

The natural reserve will add another experience for hikers and nature lovers to explore the trees and wildlife in the Yarmouk Reserve. The project promises a better life for residents, a revived tourism industry with a new element of eco-tourism. ■



عبر الخليج للمنتجات الإسمنتية ذ.م.م
Transgulf Cement Products LLC

Dubai Office:
Jebel Ali Industrial Area
P.O. Box 25595, Dubai UAE
Tel : +971 4 8801020
Fax : +971 4 8801021
email : info@tgcp.ae

Abu Dhabi Office:
P.O. Box 131329, Abu Dhabi UAE
Tel : +971 2 6797959
Fax : +971 2 6797960
email : info.auh@tgp.ae

visit our website: www.transgulf.ae

SCHOOL DESIGN

Cranleigh Abu Dhabi is a private school development for Tourism Development and Investment Company (TDIC), Abu Dhabi, located on Saadiyat Island and operated by Cranleigh – an historic private boarding school located in Surrey, UK. The design of the project was done in close association with TDIC and Cranleigh to ensure that the campus embodied the spirit, energy and quality of the existing school and campus in its setting on Saadiyat Island.

The overall school campus is made up of nine educational building elements that sit around a village green. The intention of the project was to create an integrated school campus to serve students from FS1 (4 years old) to Year 13 (18 year olds) which required the design of two main buildings with shared facilities.

The Junior School occupies the eastern-most boundary of the site and sits as a stand-alone element in the school campus concept but forming one side of the village green. The Senior School occupies the largest development footprint of the site providing over 11000m² of net accommodation across three storeys.

Within the Senior School the auditorium is the main building element – a metal clad jewel which is highly visible as a source of orientation and inspiration. The brass panels are perforated – the perforations being formed from apertures whose size and scale are taken directly from the common English brick.

The main teaching blocks are reached via the atrium space. Each department benefits from having its own front door providing the opportunity for a unique and individual visual identity for each and also to facilitate a clear way finding strategy around the school.

By: Godwin Austen Johnson



Prestigious British school in Abu Dhabi set within a village green on Sadiyaat Island



The art and technology building was specifically designed to cater for all the needs of the arts on the upper levels with the design and technology department located on the ground floor.

On the south side of the village green it was decided that the dining hall and science building would be set back a little to provide a generous

external space for both the senior and junior schools to use. Also flanking the site to the south, the sports building presents a grand backdrop to the central sports field.

And finally study houses were created which are central to the entire ethos of the school with houses assigned to each pupil within the senior school.



I SCHOOL DESIGN



Designing Cranleigh, Abu Dhabi

"In recent years, the importance of the immediate environment on a child's ability to learn and create has reached a greater understanding. Colour, texture, light and volume all come together to aid the learning process, from large noisy group activities to quiet individual study.

Learning is not just the ability to input selected information. Children are constantly learning from sights, sounds, interaction with each other and through technology. The environment can greatly improve the quality of this learning and create a sense of pride, confidence and maturity.

It is this understanding of how each particular stage in development, from child to adult, is encouraged that has determined the interior design for the public spaces, junior and senior school."

Jason Burnside, Partner at Godwin Austen Johnson

Senior School

The interiors for the senior school reflect the maturity and sophistication of the pupils by making reference to the atmosphere of a commercial office environment, rather than that of an educational institution.

Reference was made to Cranleigh's credentials and history through an underlying main palette of finishes, but each department has its own branding and entrance akin to a corporate identity.

Oak and joinery with modern detailing have been combined with a restrained palette of colours, each reflecting a separate department. Aside from the usual classroom configuration, informal meeting and study spaces are provided similar to the third spaces in a modern commercial environment. This acknowledges the increased requirement for personalised learning and e-learning in the future.

Atrium

The atrium has been designed for pupils and staff alike to utilise during the day and, out of hours and the auditorium can be used by the general public. This is the light bright heart of the campus and reflects activities for the whole community. The main entrance is located here and a reception desk welcomes guests providing assistance and information as they enter. Beyond this a central open courtyard with trees and plants provide a natural focus for the café seating area.



Different levels and walkways show constant activity around the full height of the space and bright colours and textures provide visual stimulation.

Various types of seating from benches to soft upholstery encourage impromptu gatherings and in the summer months this provides a place to congregate at break times. The auditorium is an industry standard theatre space with the atrium providing a general milling area between performances. A box office for ticket sales and collection is located at ground level.

Junior School

The junior school is made up of several departments, connected to a triple height central street where the pupils can play and interact with each other. Each department is dedicated to different groups between the ages of three and eleven. At ground level the library has soft low level seating, book display and blackboard/soft felt areas for children to draw and create pictures.

For the younger children department form and colour is at its most simplistic. Colourful, fun environments with soft surfaces, textures and unusual shapes heighten their imagination, allowing for spontaneous exploration and investigation.

Rainbow stripes break up the length of the wide connecting corridors which feature seating benches, bean bags and colourful storage boxes. Inside the classrooms the coloured shapes from the external landscaping outside extend into the classrooms. A small quiet room is provided between each pair of classrooms for quiet reading or time out.

As the child develops into a young adult, requirements for their environment becomes increasingly more sophisticated and includes the introduction of technology.

Spacious, light and airy this is a thoroughly modern establishment designed to emulate the highly respected Cranleigh in the UK. This heritage is reflected in the graphics and underlying main palette of quality finishes throughout. ■

Name of Project: Cranleigh Abu Dhabi

Photographer: Chris Goldstraw

Name of the client: TDIC

Name of contractor: Tafseer Contracting

Project location: Sadiyaat Island Abu Dhabi

Completion year: Junior School in 2014 and

Senior School in 2015

GFA = 36,824 sq mts

Powerful herbicides deliver total weed control



syngenta®

Syngenta Crop Protection

AG, Basel, Switzerland. All rights reserved. 2018. Tel: +41 61 323 1111 Fax: +41 61 323 5608
For more information visit www.greencast.ae

Exclusive Distributor in UAE and GCC
Polyclean Turf Division
T: 97143388226
F: 97143388785
M: 971506359026
Babiker.khateeb@polyclean.ae

WOODEN TOWER





LAGOS

Wooden Tower stands tall

By: Hermann Kamte and Associates

The unique wooden structure was the winner of the Inaugural WAFX Prize, which is awarded to future projects that identify key challenges that architects will need to address over the next ten years and is part of the World Architectural Festival's 10th anniversary celebrations.

The building was designed to solve housing shortages in Lagos- the most populated city in Africa with 16 million inhabitants. Situated in the heart of a housing estate in Ikory, one of the richest residential areas in Nigeria, the sustainable wooden

(Shortlisted | Plan B: City Above the City)

Lagos's Wooden Tower is a residential tall timber skyscraper in Nigeria's largest city, designed and conceptualised by Cameroonian Architecture firm, Hermann Kamte and Associates (HKA).



I WOODEN TOWER



tower represents a huge opportunity for architects and an alternative to the concrete buildings that dominate the city.

"The aim is to make a transformation that matters. Wood is marketable, serviceable, biodegradable, affordable, sustainable and ecological. The studied technology is an entire wooden skeleton with the Laminated Veneer Lumber (LVL) system for load-bearing and a non-load bearing structure," explained architects from HKA.

The old existing building is located on the highbrow Bourdillon Road with picturesque vegetation. The existing "Abebe Court" is a complex of four structures. It consists of four bedrooms and three apartments spread over four floors. Amenities include, swimming pools, gym, tennis courts, children's playground, parking lots, water treatment and sewage treatment and electricity generators. The tower is organised in three blocks above an existing structure. The blocks are connected to each other by gathering space and sports or recreational activities for residents.

The greenery in the space creates beauty, sensitivity, naturalness, aesthetics and comfort for the residents. With its microclimate effect, it is a giant lung in the urban space which helps to reduce the surrounding pollution. The terraces allow you to enjoy the sky and the city, the beautiful landscape. The roof is also a landscaped living space with a restaurant and garden.

The envelope high lights Yoruba culture with their massive presence in the heart of Lagos. Inspiration comes from the history of Edo, Yoruba. The building envelope is as sunscreen, beyond its cultural significance.



THE ROLE OF TIMBER

"Wood is an alternative to the city's reliance on less sustainable materials. Wood is a wonderful material freely offered by nature. Wood is the fingerprint of Mother Nature into our artificial buildings. It has a great role to play in the shaping for a better world; a sustainable cities, affordable housing and quality of life. Today, it is urgent to solve the housing crisis and the lack of public facilities which is at their peak. The number of poorly housed, homeless or people without access to public services is quickly rising in an uncontrolled evolution of cities." ■

AWARDS

- 2018 | German Council Design Awards, MSADA, Architizer A+ Awards, Le Monde Smart, Creative Conscience, The Plan Award, MIPIM/AR Future Projects, Inspireli Awards
- 2017 | WA Awards 26th Cycle, WAFX Prize, American Architecture Prize, Rethinking The Future Awards, World Architecture Festival, A'Design Award.

EFFICIENT, DURABLE, RELIABLE.

MP Rotator®

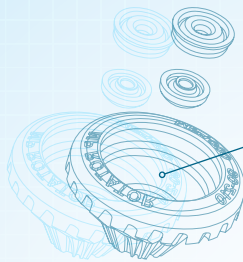

Rotor - Multi-stream, multi-trajectory technology cuts through wind and reduces misting.

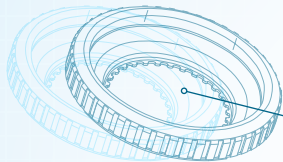

Arc ring - The MP Rotator provides a wide range of coverage from 1.5 m to 10.7 m with matched precipitation at any arc and radius.

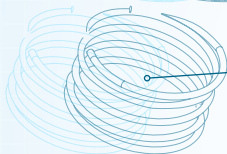

Spring - The patented double-pop feature keeps the nozzle free of external debris for increased reliability.

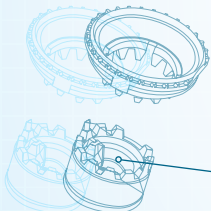

Nozzle - The MP Rotator's low application rate prevents runoff and conserves water.

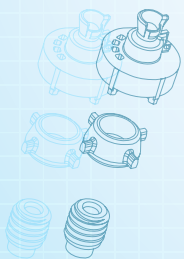

The MP Rotator is the most efficient sprinkler nozzle available on the market today. The slow application rate allows water to gently soak into the soil, with an even distribution of water throughout the irrigated area. This results in 30% less water use when compared to traditional sprays. With only one moving part and made with the highest quality materials, the MP Rotator is built for durability in even the harshest conditions.



On 28th of March 2014, The Egyptian government decided to demolish the National Democratic Party building - which was burned during the Egyptian Revolution in 2011- and to allocate its site to create an extension for the Egyptian museum in Cairo.



By: Ali Khaled Elewa
Lecturer, Helwan University



Egyptian Museum Extension at Cairo, Egypt



The idea was to link and connect the Egyptian museum to the Nile River via a direct path passing through the museum's extension, and making a marina for the cruise ships and boats in front of the museum, in addition to using the whole project surface area as a massive vegetated garden above the extension itself.

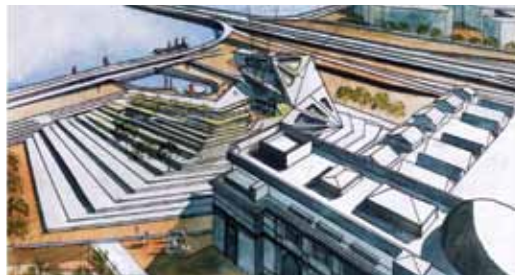
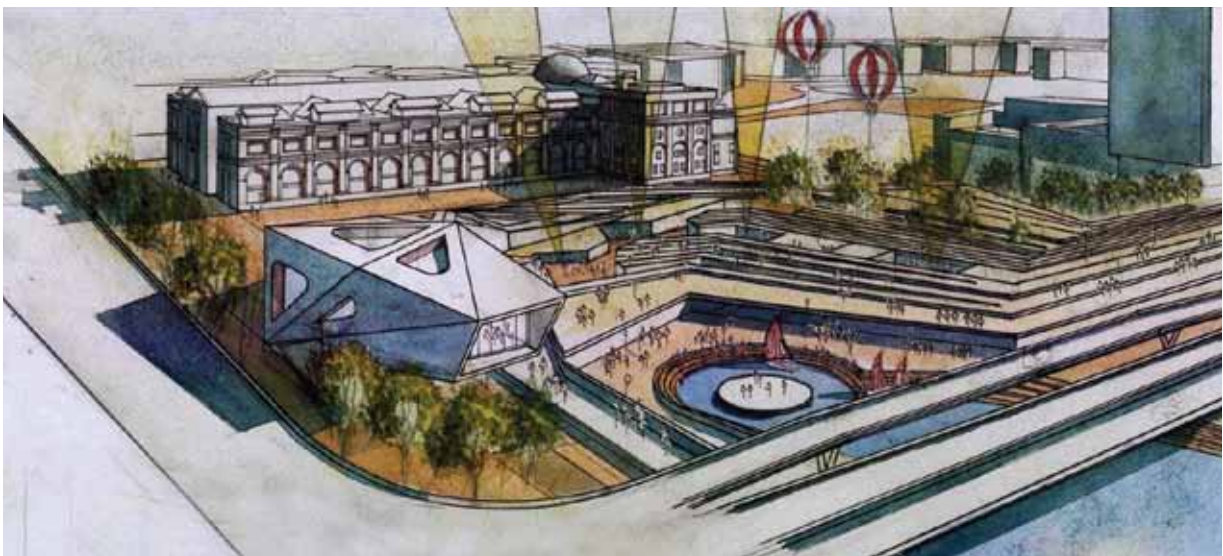

URBAN DEVELOPMENT

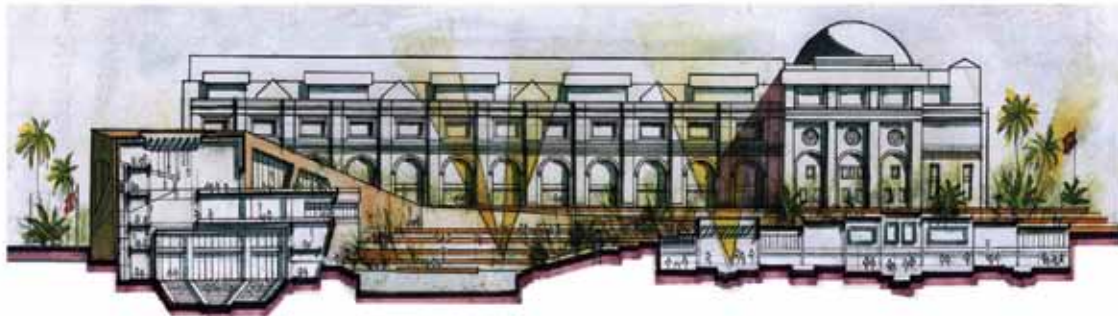
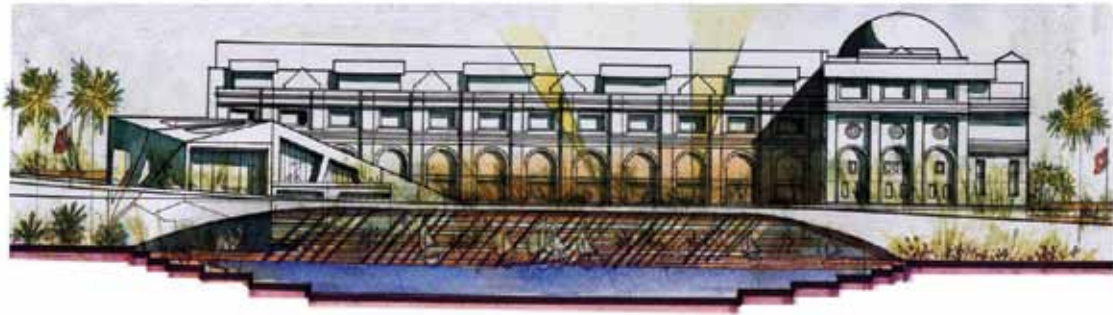

The extension was almost built underground to allow the historical museum's building to be seen from the Nile River, and exploit the whole site as a museum garden, including the external exhibition spaces.

The project consists mainly of a large museum garden for ancient Egyptian statues, temporary exhibitions, and spaces for cultural activities, multipurpose halls, auditorium, retail spaces, restaurants and cafeterias, and a great plaza surrounding the artificial lake linked with the Nile River for events and concerts.



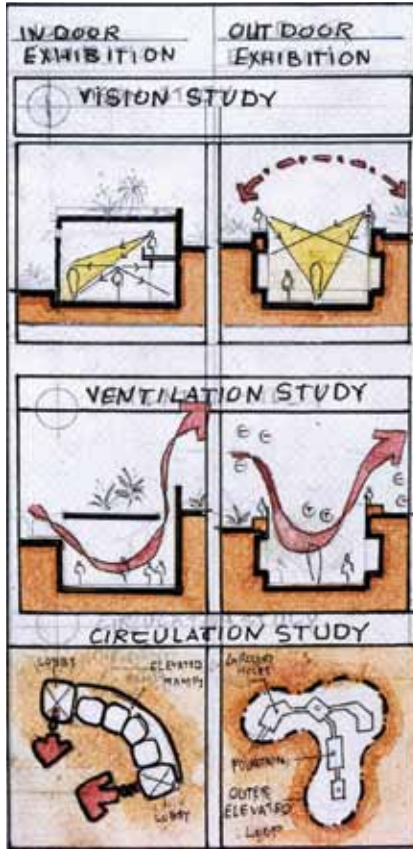

The design maximizes the garden space in order to create a green envelope that surrounds the outdoor spaces, so that they are isolated from the surrounding tall, non-historic buildings that loom large around the museum in an effort to prevent guests from being distracted.

According to the design, the project site is planned to be accessible for pedestrians only, but not vehicles, in order to reduce the air pollution, and achieving a better quality of life for the surrounding urban context. ■



- Rich Source of Plant Available Silicon
- Improves Crop Yields
- Improves Crop Quality
- Approved input for Organic Agriculture

مصدر غني بالسيليكون المتاحة للنبات
يحسن من إنتاجية المحاصيل
يحسن من جودة المحاصيل
مدخل معتمد للزراعة العضوية



Agrisilica GRANULE IS AVAILABLE IN:

- 25 KG BAGS - 50 KG BAGS - BULK BAGS - BULK



المملكة العربية السعودية
شركة الدعم الزراعي المحدودة - أسكو
Kingdom Of Saudi Arabia
Agriculture Support Company Ltd (ASCO)
info@agritech-group.com

سلطنة عمان
شركة الدعم الزراعي المحدودة
Sultanate of Oman
Modern Majan Deserts
info.agrisoil@agritech-group.com

الإمارات العربية المتحدة
شركة أجري سويل لتجارة الأسمدة العضوية
United Arab Emirates
AgriSoil for Organic Fertilizers Trading
info.agrisoil@agritech-group.com

الشرق الأوسط
أجري تيك دي ام سي سي
Middle east
Agritech DMCC
info@agritech-group.com



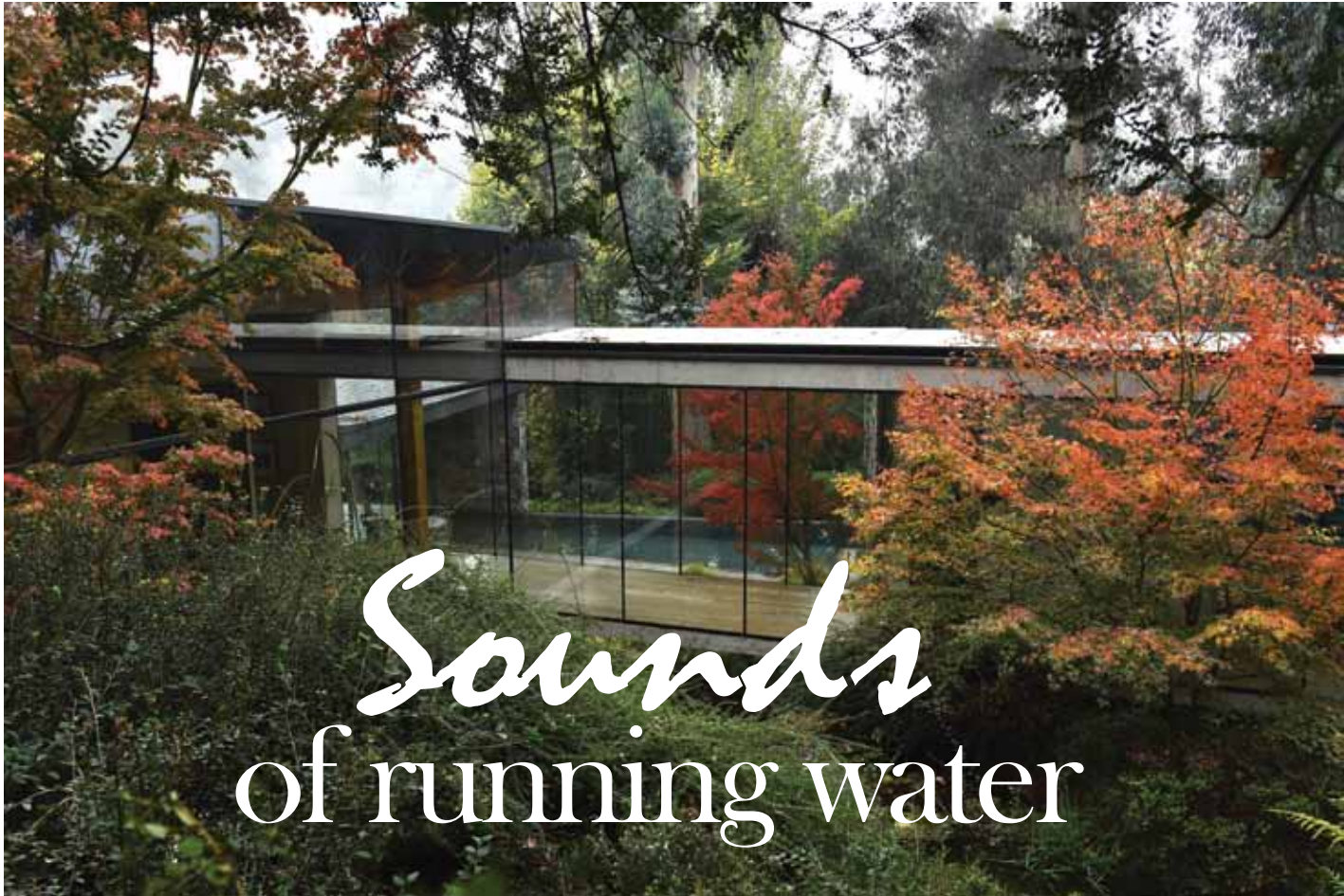



This large residential garden is located in Lo Curro Hill, part of the Manquehue Mountain Range, in Santiago de Chile. An exclusive neighbourhood in the Chilean capital, positioned on the northern shore of the Mapocho River and surrounded by nature - an ideal location for a secret garden.

Part of the irrigation system is based on the use of an existing distribution channel coming from a stream which borders the land's upper area. The site has a series of pools and tanks that the water passes through before draining into an irrigation ditch. Ferns and large-leafed plants conceal the water, although the noise of the falling water is still there.

This preexisting water system and the dense planting around the lot was the catalyst for the design inspiration for architects and landscape designers to create a project where house and garden become one within the natural setting. Landscape architect Juan Grimm says "The architecture is wrapped with the garden which in turn follows the direction of the descending water".

The natural grade of the site was the basis for the overall project design. As a result, there are different indoor and outdoor living areas, which either face the descending brook or allow it flow through.

Access to the project is via a gravel path edged by dense planting, leaving only part of the house visible, while the secret garden descends towards an apparently infinite land encased within existing woods. A couple of red oaks (*Quercus Rubra*) and a large Eucaliptus existed in this first portion of the land and, a little downhill in the site, lies a group of elms (*Ulmus* sp); pruned and conserved at their original positions, the trees were set as conditioning elements for the architectural and garden layout. For this reason, the path which goes around the house was defined with a zigzag-shaped rocky edge in response to the trees' location, making their large trunks and crowns stand out in the site.

In order to incorporate the group of elms into the new layout and to highlight the autumn foliage they provide, Juan

By: Jimena Martignoni



PARKS



Grimm added some ginkgos (*Ginkgos bilobas*) and completed the existing cluster. During the fall, this vibrant image is the one who welcomes the visitor and, for the owners and those inhabiting and enjoying the house, becomes almost a painting to be serenely appreciated from the living room. The decision to build the living and dining areas as transparent volumes brings the garden intimately closer to the interior spaces and creates wide and long vistas toward the woods and the ever-flowing water.

The level of the living room, which floats over the garden's main path, coincides with the first "water stations", pools of still water defined by retaining walls which negotiate the site's elevation change, these areas became also ornamental arrangements in the landscape.

The main path of the garden goes all the way up to the highest point of the lot, where there is a water collecting fountain that descends and goes through the house. This same path also leads to the lot's lowest point where the garden becomes a shady humid and evergreen composition. On its way down, this trail is fully planted and exhibits diverse types of ferns, poppy anemones (*Anemone coronaria*),

bigleaf hydrangeas (*Hydrangea* sp) and some large trees such as holly oaks (*Quercus ilex*).

Water flows down along the full extension of this wild itinerary, at some points retained and at some others openly displayed, yet always circulating, subtly but ceaselessly, and producing charming settling sounds.

At the point of the house where the dining room meets with a connecting glass-enclosed walkway, the water was piped to simply go through, underneath the building and the garden, following the land undulations and the architectural layout. The result is an intimate green space which seems to naturally get into the house, almost as an additional room, blurring all limits between landscape and architecture, water and land, the hidden and the open. ■

Location: Santiago de Chile, Chile.

Landscape Architect: Juan Grimm

Architectural Plan: Martin Schmidt

Total Area: 3, 250 m2

Date of completion: 2010

Photography: Renzo Delpino



*Contributing Big in Middle East Landscape By
Providing Quality Plants & Trees For Last*

25 Years



Plants for Ever

PRODUCERS AND EXPORTERS OF LIVE PLANTS / TREES



**RAINBOW
INTERNATIONAL
INDIA**

Wide Range Of

- ♦ Shrubs
- ♦ Palms
- ♦ Ground Covers
- ♦ Trees
- ♦ Succulents,
- ♦ Fruit - Plants etc.

Phone: +91 - 98250 46213
+91 - 2692-247111

E-mail: sales@rainbow-agri.com
rainbowagri87@gmail.com

Web: www.rainbow-agri.com

BOOKS OF INTEREST



URBAN ENVIRONMENTAL LANDSCAPE

ISBN: 9781864706307
Author: Dieter Grau
Hardcover: 256 pages
Publication Date: (10 Jun. 2015)

Book Descriptions:

The book provides the latest trends in urban environmental landscaping, with informative chapters on basic principles, dimensions, reference standards and considerations across

a range of themes, such as public parks, public plazas, waterfront public open spaces, and urban street environments. It showcases a broad range of informative high-quality projects spanning the United States, Mexico, Australia, China, and Europe and provides comprehensive reference material for architects, urban planners, preservationists, and landscape designers, and all who are directly involved in town planning in the urban environment. For each part, we selected the most striking cases with the newest design standards to showcase spectacular landscape design.

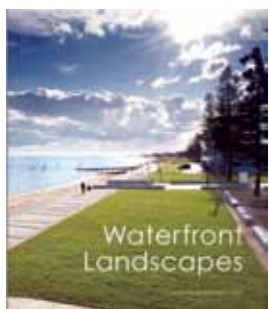

WATERFRONT LANDSCAPING

Publisher: DesignMedia Publishing Limited
(December 26, 2011)
ISBN: 9789881545213
Hardcover: 272 pages
Price: 159AED

BOOK DESCRIPTION:

"Waterfronts continually evolve, moving through phases and meanings. Today, the landscape urbanism and waterfront reclamation movements

are inextricably linked and are now as inevitable as the rising sun. More than seams between city and water, waterfronts are metaphorical links between our past, present and future. The book selects and showcases 46 of the very latest projects of waterfront landscape designs, from around the world. These projects respond to different design challenges with a commitment to providing responsible and innovative solutions. With highly illustrated images, professional design drawings and detailed texts, the book offers readers a large variety of methods and visions for approaching waterfront.



COMMUNITY LANDSCAPE DESIGN

ISBN: 9789881296887
PUBLICATION DATE: 1 Aug. 2014
HARDCOVER: 288 pages

BOOK DESCRIPTION:

As the world is undergoing rapid urbanization and demands for good housing in cities soar, we are looking for residential environment where we can take refuge from our intense and hectic lifestyle. This enticing book is a window

to a diverse range of community landscape design creating exceptional living environment across the globe addressing this need of high-quality housing. This stimulating book is divided into three sections: high-rise residential tower landscape, mid-rise residential block landscape and low-rise villa landscape as each category has its unique landscape character. Included projects demonstrate how landscape architects integrate the key parameters; culture, context, sustainability and budget making it a useful reference to both landscape design professionals and enthusiasts.



With its headquarter in Tokyo, Japan and world class stores spread over countries like America, Singapore, Indonesia, Malaysia, Thailand, Australia, Taiwan and now in DUBAI – UAE, Kinokuniya is a globally known book seller of repute.

The store in Dubai Mall is a massive 68,000 square feet wide paragon book gallery which stocks more than half a million books and thousand magazines in English, Arabic, Japanese, French, German and Chinese at any given time.

The Store is also a distinct cross cultural hub wide range of time to time multicultural events such as a comic art demonstrations, language learning workshops, book launches etc.

The pleasant ambiance, stenographic design and add to it the impressive view of modern skyline – world's tallest building, Burj Khalifa, Kinokuniya at The Dubai Mall is just the place to evoke emotions and add pleasure to your book shopping. You may like to visit our website for more information. www.kinokuniya.com

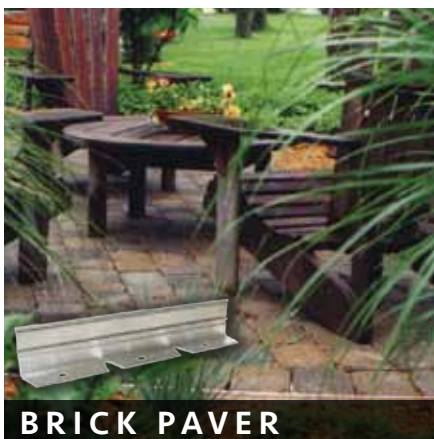

DISTRIBUTED BY:



TANSEEQ
tanseeqlc.com
info@tanseeqlc.com
+971 4 3617199

A project is defined by its lines. For over 30 years, Permaloc has dedicated itself to developing **edging and restraint products** that assure your project's edges will be sustained for its lifetime.

Permaloc offers **13 application-specific product lines**, assuring we have a product to match whatever your need. With **flat edgings** from 3" to 12" in height, and **"L"-shaped edgings** from 1" - 8.5", both available in a **variety of thicknesses**, our products will meet all of your edging needs.

Permaloc provides the highest quality aluminum products for use in landscape, hardscape and green build.

Find us at **permaloc.com** or contact us at **1.616.399.9600**



Landscape Bed • Maintenance Strip • Aggregate Walkway • Brick Paver • Permeable Pavement • Asphalt Surface • Sports Surface • Green Roof

COMPANY LISTINGS

LANDSCAPE CONTRACTOR

► Nakheel Landscapes

T: +974 44085333
F: +974 44983420
info@nakheelandscapes.com
www.nakheelandscapes.com

► Desert Group

T: +971 4 3404440
T: +971 4 34044416
group@desertgroup.ae
www.desertgroup.ae

BUILDING MATERIALS

► Creative Concrete Concepts

T: +971-6-532- 1119
F: +971-6-532-8833
www.tex-crete.com
info@tex-crete.com

► Hepworth

T: +971 4 2894670
F: +971 4 2894620
www.hepworth.ae

FOUNTAIN

► Watermaster

T: +974 4 4442494
F: +974 4 4375923
jtaouk@watermasterqatar.com
www.watermaster.me

► OASE Living Water

T: +971 4299 4847
F: +49 5454 809412
uae@oase-livingwater.com
www.oase-livingwater.com

TURF/LANDSCAPE PROFESSIONAL PRODUCTS

► Polyclean LLC

(Turf Division)
T: +971 4 338 8226
F: +971 4 338 8785
babiker.khateeb@polyclean.ae
riyad.mustafa@polyclean.ae
www.polyclean.ae

LANDSCAPE PRODUCTS

► WT Burden

T: +971 4 8860700
F: +971 4 8860701
streetfurniture@wtburden.ae
www.wtburden.ae

► Tanseeq LLC

T: +971 4 3617199
F: +971 4 3607966
info@tanseeqllc.com
www.tanseeqllc.com

IRRIGATION

► Hunter Industries

T: +001 760 591 7114
F: +001 760 591 7194
Hanna.Zaidan@hunterindustries.com
www.hunterindustries.com

► METTS Fzc

T: +971 4 4470927
F: +971 4 4470928
info@mettsfzc.com
www.mettsfzc.com

► Alwasail Industrial Co.

T: +971 4 8886987
F: +971 2 6733565
hashim@alwasail.com
www.alwasail.com

► Rain Bird

T: +971 4 8819671
F: +971 4 8819672

TREES & HERBS

► Orientalis

T: +971 4 429 00 44
F: +971 4 422 52 96
info@orientalis.co
www.orientalis.co

SPORT'S FACILITIES / PLAYGROUND EQUIPMENTS

► Raymond Sport

T: +971 4 3391331
T: +971 2 4499196
F: +971 4 3391080
office@raymondssport.com
www.raymondssport.com

ACQUATIC PLAY

► Vortex

T: +15146943868
info@vortex-intl.com
www.vortex-intl.com

SWIMMING POOL

► Olympic Swimming Pools Installation LLC

T: +971 4 3362266
F: +971 4 3355299
info@ospools.com
www.ospools.com

► Pentair

T: +971 4 44470927
F: +971 4 4470928
malikhan@mettsfzc.com
www.mettsfzc.com

► Satma International L.L.C.

T: +971 4 2956088
F: +971 4 2956077
satmaint@emirates.net.ae
www.satma.ae

SOIL ADDITIVES

► Zeoplant LLC

T: +971 4 4473588
F: +971 4 4473587
info@zeoplant.com
www.zeoplant.com

► Agri Soil Organic Fertilizer Trading

T: +971 4 2765988
F: +971 42765977
Mob +971559995196
info.agrisoil@agritech-group.com
www.agripower.com.au

METAL FABRICATOR

► m-tec

T: +466 125 4773718
info@m-tec.uk.com
www.m-tec.uk.com

List your company
in our Listing
Page that reaches
thousands of
subscribers

Book your space Now!

Contact: admin@landscape-me.com • Tel: +971 4 4470927

AED
250
per month



MIDDLE EAST
SMART LANDSCAPE
SUMMIT 2019

MIDDLE EAST'S LEADING EVENT ON BUILDING
HEALTHY NATURAL ENVIRONMENTS AND
SUSTAINABLE COMMUNITIES

FAST FACTS



400+
Senior Delegates
Attended



150+
Top Companies
Represented



40+
Industry Expert Speakers
from Around the World



20+
Industry Relevant
Topics



10+
Hours of
Networking

18-19
MARCH 2019
Roda Al Bustan
Dubai, UAE

GOLD SPONSORS



BRONZE SPONSORS



NETWORKING SPONSOR

Hepworth

SACHEL INSERT SPONSOR

Hunter®

NEW ONGOING PROJECTS



middleeasttenders.com

+971 2 634 8495

YOUR SELECTED SEARCH CRITERIA:

STATUS : NEW TENDER

TRADE CATEGORY : AGRICULTURAL, LANDSCAPING AND IRRIGATION

NEW & CURRENT PROJECTS

Tender Name	Description	Client	Region	Tender Cost (USD)	Post Date	Closing Date
Agricultural Production Requirements	Provision of Agricultural Production Requirements	Ministry of Climate Change & Environment (Dubai)	Dubai	272	1/31/2019	2/27/2019
Agricultural Production Requirements	Supply of Agricultural Production Requirements	Ministry of Climate Change & Environment (Dubai)	Dubai		1/31/2019	2/27/2019
Gardens, Lawns & Trees Maintenance	Maintenance of Gardens, Lawns and Trees	Public Authority for Radio & Television (Oman)	Oman	64	2/3/2019	2/26/2019
Cycleways, Footbridges & Landscaping Design & Build	Design & Build of Cycle-ways, Footbridges & Landscaping	Public Works Authority - ASHGHAL (Qatar)	Qatar	2747	1/22/2019	2/26/2019
Garden Rehabilitation Works	Rehabilitation of Garden	Dhofar Municipality (Oman)	Oman	192	1/31/2019	2/25/2019
Plantations and Gardens O&M	Operation and Maintenance of Plantations and Gardens	Riyadh Municipality (Saudi Arabia)	Saudi Arabia	2667	12/27/2018	2/24/2019
Plantations and Gardens O&M	Operation and Maintenance of Plantations and Gardens	Riyadh Municipality (Saudi Arabia)	Saudi Arabia	2667	12/27/2018	2/24/2019
Agriculture Materials	Supply of Agriculture Materials	Ministry of Defence (Kuwait)	Kuwait	268	1/29/2019	2/17/2019
Soft Landscaping Works	Provision of Soft Landscaping Works	Supreme Committee for Delivery & Legacy (Qatar)	Qatar	687	1/23/2019	2/17/2019
Green Space Maintenance, Cleaning and Refurbishment Works	Maintaining Green Space, Cleaning and Refurbishing Works	Abadan Oil Refining Company (Iran)	Iran		1/15/2019	2/13/2019
Main Reservoirs and Irrigation Mains Upgrade	Upgrading of Main Reservoirs and Irrigation Mains	Abu Dhabi General Services Company PJSC (Musandam)	Abu Dhabi		2/3/2019	2/12/2019
Main Reservoirs & Irrigation Mains Upgrade Works	Design and Build Upgrade of Main Reservoirs and Irrigation Mains.	Abu Dhabi General Services Company PJSC (Musandam)	Al Ain	1359	2/3/2019	2/12/2019
Al Shaheed Garden Development	Development of the Design, Construction and Maintenance of Al Shaheed Garden	Amiri Diwan (Kuwait)	Kuwait	35714	1/28/2019	2/12/2019
Baled Rhodes Grass Hay	Supply of Baled Rhodes Grass Hay	Sultan Qaboos University (Oman)	Oman		2/3/2019	2/11/2019
Consultancy Services	Provision of Services for the Development of Management Plans for Rangelands outside Forests (RMP)	United Nations Development Programme - UNDP (Lebanon)	Lebanon		1/16/2019	2/11/2019
Road & Utilities Construction Works	Construction of a Road and Utilities	Royal Commission for Jubail & Yanbu (Saudi Arabia)	Saudi Arabia	267	1/3/2019	2/11/2019
Painting, Trees Planting, Rubble Removal Works	Painting Curb Stones, Planting Trees, Removing Rubble and Re-Arranging Loam of Main Roads	United Nations Development Programme - UNDP (Iraq)	Iraq		1/24/2019	2/10/2019
Gardens and Plantations Maintenance	Care, Maintenance and Rehabilitation of Gardens, Internal and External Plantations in the Community College Buildings	Community College of Qatar (CCQ)	Qatar	137	1/23/2019	2/10/2019
Landscaping Services	Allocating a Proportion of the Landscape to Build a Pedestrian Walkway	Ministry of Municipality & Environment (Qatar)	Qatar	275	1/22/2019	2/10/2019
Gardens and Irrigation System Maintenance	Providing Maintenance Services for Gardens and Irrigation System	Qatar Media Corporation (Q.media)	Qatar	206	1/22/2019	2/10/2019
Agriculture Maintenance Outsourcing Services	Outsourcing of Agriculture Maintenance	Ajman Municipality & Town Planning Department	Northern Emirates	136	1/20/2019	2/10/2019

Tenders
www.MiddleEastTenders.com

Get the latest Tenders and Project Information in the Middle East

P.O.Box 2534 , Abu Dhabi, UAE Tel- +9712-6348495 Fax- +9712-6316465 Email: info@middleeasttenders.com

CRYING ABOUT HIGH WATER BILLS? CALL US TO EASE YOUR PAIN!

After successfully working in
newly built projects for over
15 years, we have now
entered a new field:

Treatment of Existing Turf & Landscape



More online here



Retro-application @ Date Palms



Solid Tining Zeoplant into existing lawns



Zeoplant – We are always a step ahead.

zeoplant



زيوبلانت



metts

Designing & Auditing Irrigation Networks

*To reduce
your water bills*

| info@mettsfzc.com | www.mettsfzc.com

Irrigation Service Provider